

0A-1487-6853			
INDEX	NAME	QTY	DESCRIPTION
1	0M-3851693	1	FIBER CONVERTER MTGING PLATE; RTX-C1
2	0P-2072-0002	2	FIBER OPTIC CONV; COATED, W/ 4GBPS FIBER TR
3	0S-3851697	1	ENCL; FIBER CONVERTER CARD, BASE
4	HC-1012	4	MACH SCR, #6-32 X 0.375, PHIL PAN HEAD, ZN PLTD
5	HC-1435	5	RIVET, 3/16 X 0.250 AL/SS, CE SEALING
6	HC-3601959	1	TAP SCR; #10-32 X 0.25, SLTD HEX WSHR HEAD, ZN PLTD
7	HE-1155	8	STANDOFF, 6-32X1/2 M-F HEX, BRASS, MALE 1/4" LONG
8	HS-1142	1	NUTSERT, 6-32 THREADED 7/32" HOLE FOR

TORQUE SPECIFICATIONS	
HC-1012	10 IN-LBS
HC-3601959	27.5 IN-LBS
HC-1179	10 IN-LBS
HE-1155	10 IN-LBS

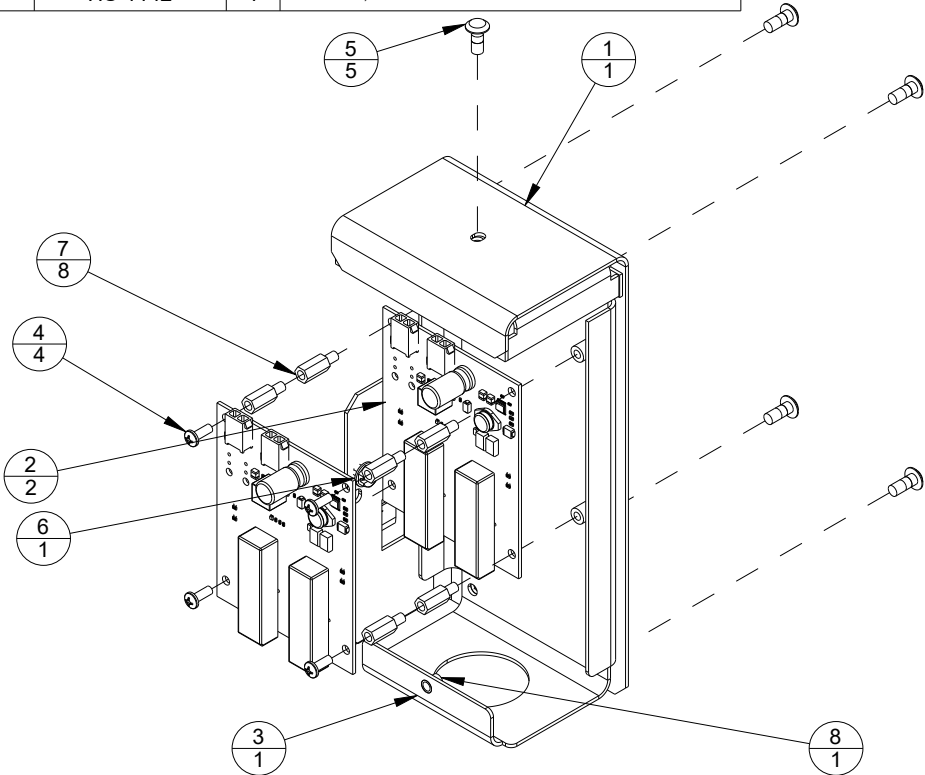

0A-1487-6853			
INDEX	NAME	QTY	DESCRIPTION
1	0M-3851695	1	ENCL, FIBER CONVERTER CARD, COVER
2	0P-2072-0002	2	FIBER OPTIC CONV; COATED, W/ 4GBPS FIBER TR
3	HC-1179	1	MACH SCR, #6-32 X 0.250, PHIL PAN HEAD, BLK PLTD

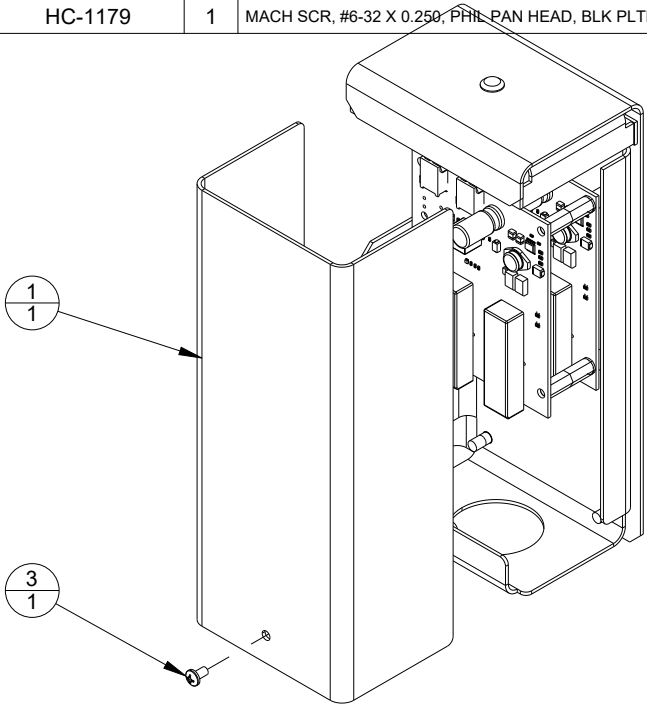

FIBER CONVERT HOOK MOUNT
REMOVE #10 SCREW (HC-3601959) AND
SECURE INTO HOOK MOUNT BRACKET.
TIGHTEN TO 27.5 IN-LBS

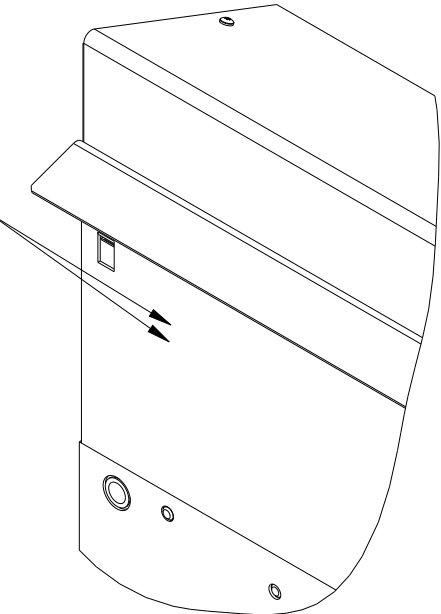

ROTATED REAR VIEW
(BEVERAGE SHROUD REMOVED)
SCALE 1/5

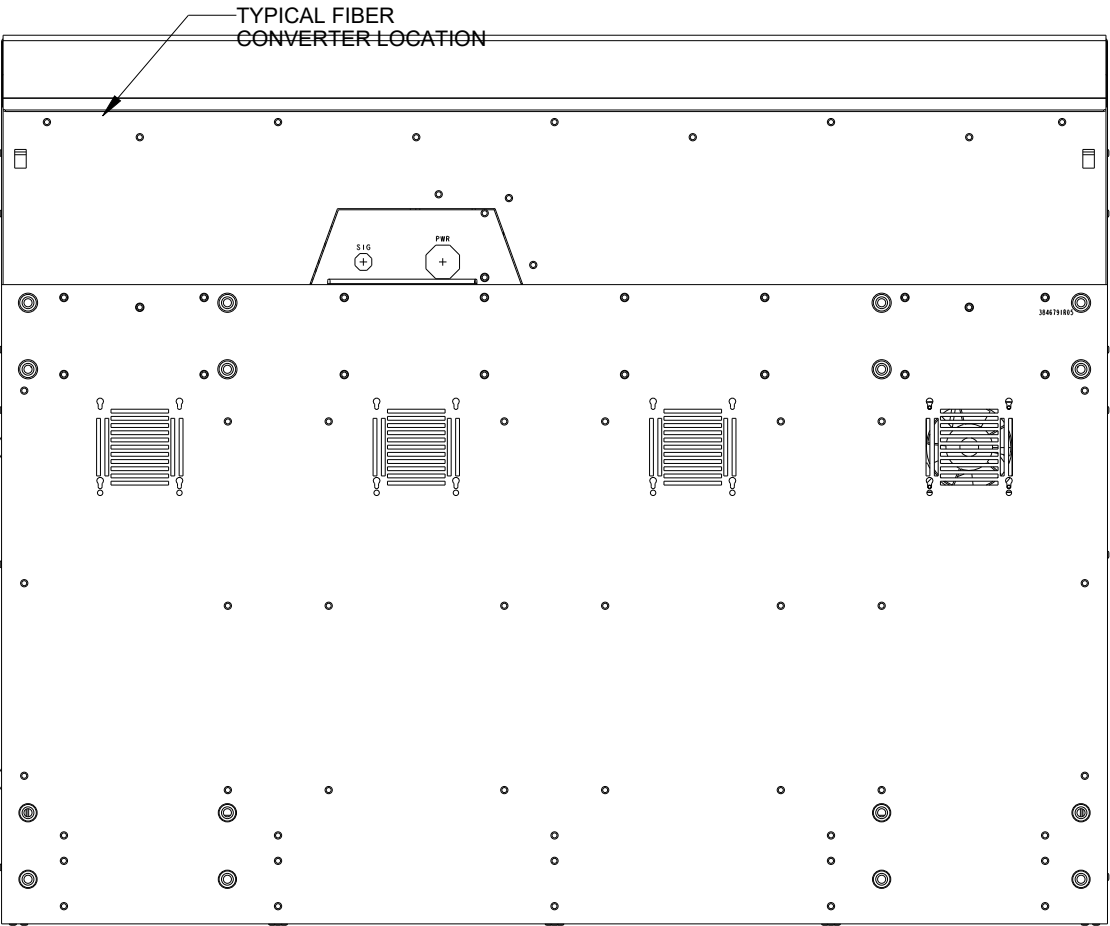

REAR VIEW
(BEVERAGE SHROUD REMOVED)

01	03 JAN 23	CN151336 CHANGED FROM 0P-1273-0062 TO 0P-2072-0002	JSF	
REV	DATE:		BY:	
PROJECT: RTX-C1		TITLE: ASSY; SM TO MM FIBER CONVERTER CARD @2, RTX-C1		
DATE: 03-JAN-23		DIM UNITS: INCHES [MILLIMETERS]		SHEET 1 OF 1
SCALE: 1/3		DO NOT SCALE DRAWING		REV 01
DESIGN: RBJERKE		JOB NO. P2028	FUNC - TYPE - SIZE E - 07 - B	3859885
DRAWN: RBJERKE				